

Miniature Loadcell



Compression

MODEL 247C

Without bottom tap hole

Φ17 × 10mm Height

Capacity from 5kg to 500kg

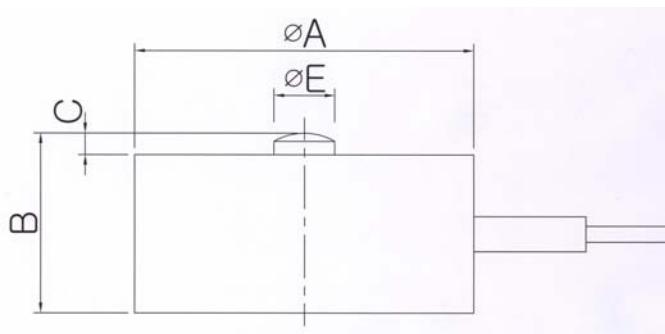

SPECIFICATION

Model	247C
Rated Capacity (R.C)	5kg, 10kg, 20kg, 50kg, 100kg, 200kg, 500kg Compression only
Rated Output (R.O)	1.0 mV/V ± 10%
Non-linearity	± 0.2% R.O.
Hysteresis	± 0.2% R.O.
Repeatability	± 0.1% R.O.
Zero Balance	± 10% R.O.
Excitation, Nominal	3VDC
Excitation, Maximum	5VDC
Resistance, Input	350 Ohm ± 10 Ohm
Resistance, Output	350 Ohm ± 5 Ohm
Insulation Resistance	1000 Mega Ohm, Minimum
Temp.Range Operated	-5 ~ 60℃
Temp. Coef. Zero	±0.5% R.O. /10℃
Temp. Coef. Span	±0.5% Load /10℃
Safe Overload	150% R.C.
Cable	φ3mm PVC Jacket, 4C, Shielded cable 2m length
Cable color code	Red (+EXC), Black(-EXC), Green (+SIG), White(-SIG), Bare(Shield)

Dimension				
Capacity	A	B	C	E
5kg	Φ17	10	2	Φ2.6
10kg ~ 200kg	Φ20	11	2	Φ2.6
500kg	Φ20	15	3	Φ2.6

Feature

- Miniature load cell for compression
- Compact size for limited space

Application

- Precision force measurement